

Exhibit C - Job No. 2021-1 (L)

Parcel ID	Tax Parcel Number	Tax Payer	Delivery Address	City State	Zipcode	Site Address	Land Acres	Land Acre Percentage	Latecomer Assessment Percentage Per Square Foot	4% Maintenance Fee	Assessment and 4% Maintenance Fee
									\$3,266,384.54 VIKING JV LLC		
									CONSTRUCTION COSTS		
									MINUS THE \$600,000.00		
									PMF AND CITY OF PUYALLUP		
									CONTRIBUTION		
									\$2,666,384.51 LATECOMER		
									REIMBURSEMENT TOTAL		
0	420252002	KNUTSON FARMS INC	16406 78TH ST E	SUMNER, WA	98390-2900	6719 134TH ST	8.6600	3.03121%	\$ 80,823.80	\$ 3,232.95	\$ 84,056.75
1	420252003	KNUTSON FARMS INC	16406 78TH ST E	SUMNER, WA	98390-2900	XXX 134TH AV E	1.5000	0.52504%	\$ 13,999.50	\$ 559.98	\$ 14,559.48
2	0420252012	KNUTSON FARMS INC	16406 78TH ST E	SUMNER, WA	98390-2900	XXX 134TH AV E	2.6100	0.91356%	\$ 24,359.13	\$ 974.37	\$ 25,333.50
3	0420252056	KNUTSON FARMS INC	16406 78TH ST E	SUMNER, WA	98390-2900	XXX RIVER ST	2.1000	0.73505%	\$ 19,599.30	\$ 783.97	\$ 20,383.28
4	0420252700	KNUTSON FARMS INC	16406 78TH ST E	SUMNER, WA	98390-2900	XXX 134TH AV E	23.4600	8.21158%	\$ 218,952.22	\$ 8,758.09	\$ 227,710.31
5	0420252701	KNUTSON FARMS INC	16406 78TH ST E	SUMNER, WA	98390-2900	XXX RIVER ST	5.4000	1.89013%	\$ 50,398.21	\$ 2,015.93	\$ 52,414.14
6	0420253005	WULFEKUHLE MARCUS S & LESLIE P	13925 80TH ST E	PUYALLUP, WA	98372-3614	13925 80TH ST E	4.6400	1.62411%	\$ 43,305.13	\$ 1,732.21	\$ 45,037.33
7	0420253007	KNUTSON FARMS INDUSTRIAL PARK LLC	7701 FORSYTH BLVD STE 900	SAINT LOUIS, MO	63105-1840	XXX 134TH AV E	3.0000	1.05007%	\$ 27,999.01	\$ 1,119.96	\$ 29,118.97
8	0420253011	SLAMA M MICHAEL TTEE	2901 ROOSEVELT AVE	RICHMOND, CA	94804-1541	7608 142ND AV E	4.0000	1.40010%	\$ 37,332.01	\$ 1,493.28	\$ 38,825.29
9	0420253022	SLAMA M MICHAEL TTEE	2901 ROOSEVELT AVE	RICHMOND, CA	94804-1541	XXX 141ST AV E	6.7500	2.36267%	\$ 62,997.76	\$ 2,519.91	\$ 65,517.67
10	420253031	WULFEKUHLE MARCUS S & LESLIE P	13925 80TH ST E	PUYALLUP, WA	98372-3614	13919 80TH ST E	0.6800	0.23802%	\$ 6,346.44	\$ 253.86	\$ 6,600.30
11	0420253036	KNUTSON FARMS INDUSTRIAL PARK LLC	7701 FORSYTH BLVD STE 900	SAINT LOUIS, MO	63105-1840	7215 134TH AV E	0.4587	0.16056%	\$ 4,281.05	\$ 171.24	\$ 4,452.29
12	0420253056	NORTHWEST PIPELINE CORP	PO BOX 2400	TULSA, OK	74102-2400	XXX 142ND AV E	1.3099	0.45850%	\$ 12,225.30	\$ 489.01	\$ 12,714.31
13	0420253057	KNUTSON FARMS INDUSTRIAL PARK LLC	7701 FORSYTH BLVD STE 900	SAINT LOUIS, MO	63105-1840	7301 134TH AV E	0.8699	0.30449%	\$ 8,118.78	\$ 324.75	\$ 8,443.53
14	0420253063	KNUTSON FARMS INDUSTRIAL PARK LLC	7701 FORSYTH BLVD STE 900	SAINT LOUIS, MO	63105-1840	13423 74TH ST E	1.0399	0.36399%	\$ 9,705.39	\$ 388.22	\$ 10,093.60
15	0420253064	KNUTSON FARMS INDUSTRIAL PARK LLC	7701 FORSYTH BLVD STE 900	SAINT LOUIS, MO	63105-1840	XXX 134TH AV E	0.7199	0.25198%	\$ 6,718.83	\$ 268.75	\$ 6,987.58
18	0420253070	STEP BY STEP FAMILY SUPPORT CENTER	PO BOX 488	MILTON, WA	98354	3303 TO 3301 8TH AV SE	3.7500	1.31259%	\$ 34,998.76	\$ 1,399.95	\$ 36,398.71
19	0420253071	STEP BY STEP FAMILY SUPPORT CENTER	PO BOX 488	MILTON, WA	98354	3303 8TH AV SE	2.4800	0.86806%	\$ 23,145.84	\$ 925.83	\$ 24,071.68
20	0420253702	KNUTSON FARMS INC	16406 78TH ST E	SUMNER, WA	98390-2900	XXX 80TH ST E	9.5900	3.35674%	\$ 89,503.49	\$ 3,580.14	\$ 93,083.63
21	0420253703	KNUTSON FARMS INC	16406 78TH ST E	SUMNER, WA	98390-2900	13719 80TH ST E	16.4600	5.76141%	\$ 153,621.21	\$ 6,144.85	\$ 159,766.06
22	0420253704	KNUTSON FARMS INC	16406 78TH ST E	SUMNER, WA	98390-2900	7525 134TH AV E	33.7800	11.82383%	\$ 315,268.80	\$ 12,610.75	\$ 327,879.56
23	0420253705	KNUTSON FARMS INC	16406 78TH ST E	SUMNER, WA	98390-2900	7525 134TH AV E	33.2800	11.64882%	\$ 310,602.30	\$ 12,424.09	\$ 323,026.40
24	0420261012	KNUTSON FARMS INC	16406 78TH ST E	SUMNER, WA	98390-2900	XXX 134TH AV E	0.0899	0.03147%	\$ 839.04	\$ 33.56	\$ 872.60
25	0420264005	CAR WASH ENTERPRISES INC	3977 LEARY WAY NW	SEATTLE, WA	98107-5041	2901 E PIONEER	4.5900	1.60661%	\$ 42,838.48	\$ 1,713.54	\$ 44,552.02
26	0420264006	CAR WASH ENTERPRISES INC	3977 LEARY WAY NW	SEATTLE, WA	98107-5041	XXX E PIONEER	5.0000	1.75012%	\$ 46,665.01	\$ 1,866.60	\$ 48,531.61
27	0420264007	MASKAL THOMAS P	PO BOX 1603	NORTH BEND, WA	98045-1603	602 33RD ST SE	7.0600	2.47117%	\$ 65,890.99	\$ 2,635.64	\$ 68,526.63
28	0420264012	NORTHWEST PIPELINE CORP	PO BOX 2400	TULSA, OK	74102-2400	3112 E PIONEER	1.0799	0.37799%	\$ 10,078.71	\$ 403.15	\$ 10,481.86
29	0420264014	KNUTSON FARMS INC	16406 78TH ST E	SUMNER, WA	98390-2900	7310 134TH AV E	1.2099	0.42349%	\$ 11,292.00	\$ 451.68	\$ 11,743.68
30	0420264018	MASKAL THOMAS P & GLENNA A	PO BOX 1603	NORTH BEND, WA	98045-1603	506 33RD ST SE	5.0000	1.75012%	\$ 46,665.01	\$ 1,866.60	\$ 48,531.61
31	0420264019	MASKAL THOMAS P & GLENNA A	PO BOX 1603	NORTH BEND, WA	98045-1603	XXX 33RD ST SE	4.0800	1.42810%	\$ 38,078.65	\$ 1,523.15	\$ 39,601.79
32	0420264021	EAST TOWN CROSSING LLC	1001 SHAW RD	PUYALLUP, WA	98372	2902 E PIONEER	2.1899	0.76652%	\$ 20,438.34	\$ 817.53	\$ 21,255.87
33	0420264023	CAR WASH ENTERPRISES INC	3977 LEARY WAY NW	SEATTLE, WA	98107-5041	714 33RD ST SE	5.8600	2.05114%	\$ 54,691.39	\$ 2,187.66	\$ 56,879.05
34	0420264029	ANDREWS RALPH A & JOYCE	803 25TH ST SE	PUYALLUP, WA	98372-4125	803 25TH ST SE	0.3500	0.12251%	\$ 3,266.55	\$ 130.66	\$ 3,397.21
35	0420264033	KNUTSON FARMS INC	16406 78TH ST E	SUMNER, WA	98390-2900	XXX INTER AV	38.0400	13.31494%	\$ 355,027.39	\$ 14,201.10	\$ 369,228.49
36	0420264053	EAST TOWN CROSSING LLC	1001 SHAW RD	PUYALLUP, WA	98372	13102 E PIONEER	4.6522	1.62838%	\$ 43,418.99	\$ 1,736.76	\$ 45,155.75
37	0420264054	EAST TOWN CROSSING LLC	1001 SHAW RD	PUYALLUP, WA	98372	3104 E PIONEER	0.9949	0.34824%	\$ 9,285.40	\$ 371.42	\$ 9,656.82
42	0420268009	ROBINSON BRIAN & DINY	2502 E PIONEER	PUYALLUP, WA	98372-3530	2502 E PIONEER	0.5971	0.20900%	\$ 5,572.74	\$ 222.91	\$ 5,795.64
43	0420268010	PARK JAE IL & SEKIRA KILCHA ET AL	629 21ST ST SE	PUYALLUP, WA	98371	2502 E PIONEER	4.1000	1.43510%	\$ 38,265.31	\$ 1,530.61	\$ 39,795.92
44	0420268013	VIKING JV LLC	7701 FORSYTH BLVD STE 900	SAINT LOUIS, MO	63105-1840	302 33RD ST SE	20.4500	7.15800%	\$ 190,859.89	\$ 7,634.40	\$ 198,494.28
45	0420268014	VIKING JV LLC	7701 FORSYTH BLVD STE 900	SAINT LOUIS, MO	63105-1840	302 33RD ST SE	1.0022	0.35079%	\$ 9,353.53	\$ 374.14	\$ 9,727.68
46	0420351003	CASCADE SHAW DEVELOPMENT LLC	PO BOX 1442	GRAHAM, WA	98338-1442	808 SHAW RD	9.1100	3.18872%	\$ 85,023.65	\$ 3,400.95	\$ 88,424.59
47	0420351025	NAPP INVESTMENTS LLC	917 SHAW RD	PUYALLUP, WA	98372-7436	917 SHAW RD	0.6000	0.21001%	\$ 5,599.80	\$ 223.99	\$ 5,823.79
48	0420351026	EAST TOWN CROSSING LLC	1001 SHAW RD	PUYALLUP, WA	98372	911 SHAW RD	0.5800	0.20301%	\$ 5,413.14	\$ 216.53	\$ 5,629.67
49	0420351029	ASH DEVELOPMENT LLC	901 SHAW RD	PUYALLUP, WA	98372-7462	901 SHAW RD	0.5800	0.20301%	\$ 5,413.14	\$ 216.53	\$ 5,629.67
50	0420351030	EAST TOWN CROSSING LLC	1001 SHAW RD	PUYALLUP, WA	98372	813 SHAW RD E	0.5899	0.20648%	\$ 5,505.54	\$ 220.22	\$ 5,725.76
51	0420351066	EAST TOWN CROSSING LLC	1001 SHAW RD	PUYALLUP, WA	98372	NEXT TO SHAW RD	1.3500	0.47253%	\$ 12,599.55	\$ 503.98	\$ 13,103.53
							285.6942	100.00%	\$ 2,666,384.51		

VIKING LATECOMER SEWER LIFT STATION PARTICIPATING PARCELS



1 inch = 900 feet

Participating
Parcels

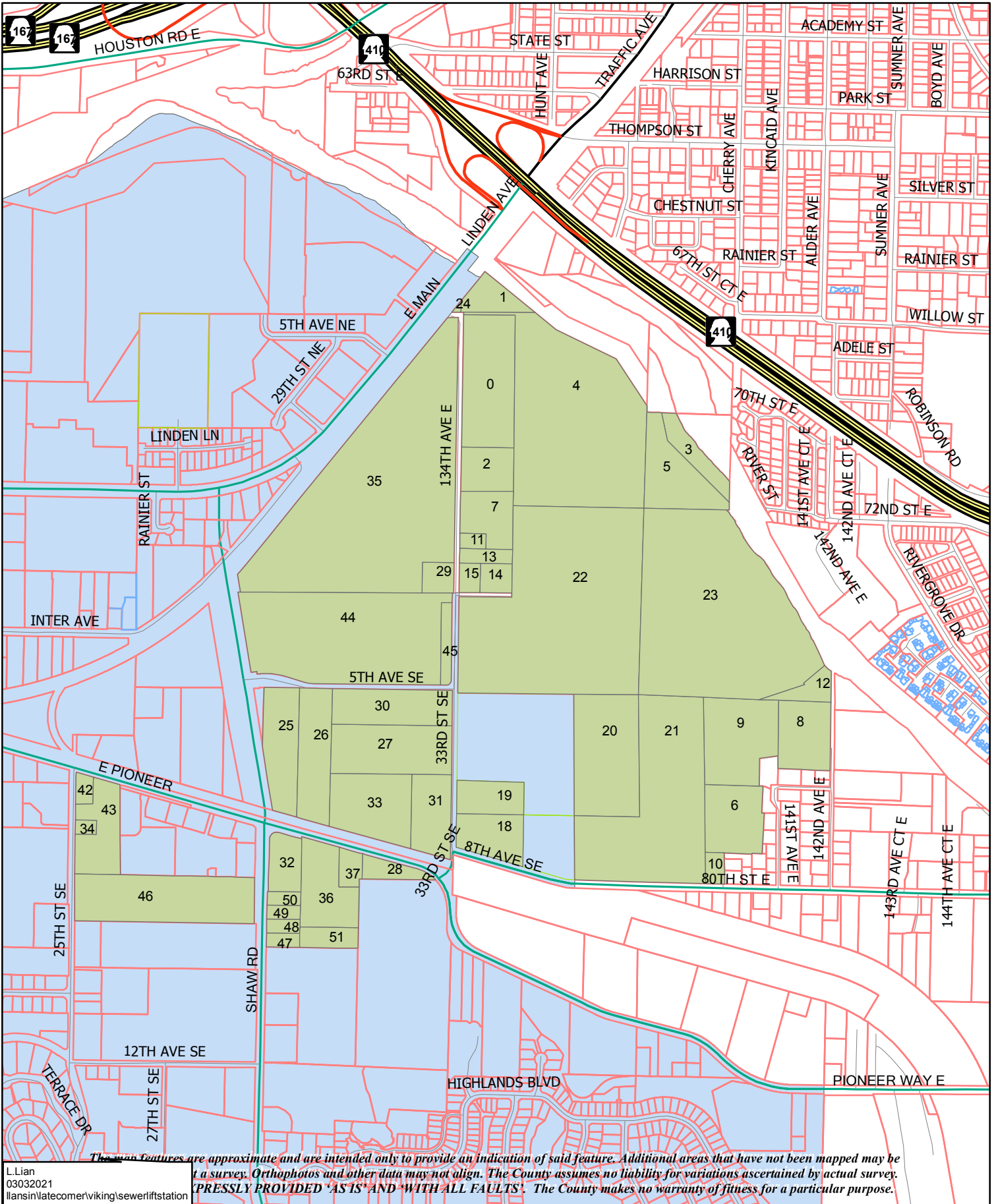

The map features are approximate and are intended only to provide an indication of said feature. Additional areas that have not been mapped may be a survey. Orthophotos and other data may not align. The County assumes no liability for variations ascertained by actual survey. PRESSELY PROVIDED 'AS IS' AND 'WITH ALL FAULTS'. The County makes no warranty of fitness for a particular purpose.